

800-601-8072

Factory Direct **CALL TODAY!**

PRODUCTS ▾

INSTALL @ BANKS

NEWS & MEDIA

ABOUT BANKS ▾

SUPPORT ▾

PROJECTS

CONTACT US

INSTALL INSTRUCTIONS

Part #s 42255, 42255-D

Banks Ram-Air® Intake System
2013-2018 Ram 6.7L Cummins
Pickup Trucks

Please read through the following instructions thoroughly before starting your installation. If you have any questions please visit our [Support Page](#).



General Installation Practices

Tools Required:

1. 3/8" drive ratchets with metric sockets
2. Standard and Phillips head screwdriver
3. Standard and needle-nose pliers
4. Clean shop towels or rags
5. 5/16" nut driver
6. T-30 driver

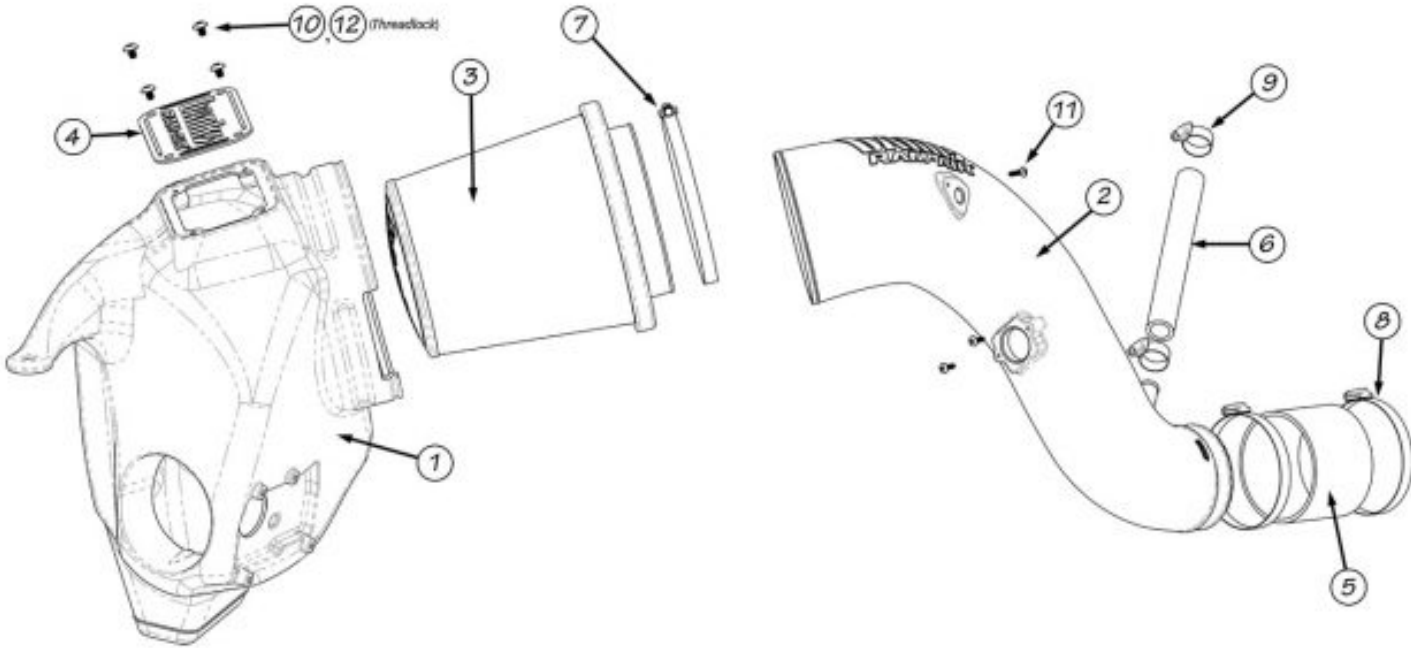

General Assembly

Item #	Description	Part #	QTY
1	Housing	42256	1
2	Intake Tube	42258	1
3	Air Filter	42141	1
4	Window	41788	1
5	Hose, Compressor Inlet	94303	1
6	Hose, PCV, 3/4"	94143	7.5"
7	Hose Clamp, #104	92904	1
8	Hose Clamp, #64	92864	2
9	Hose Clamp, #16	92816	2
10	Screw, 1/4 - 20x3/8"	91128	4
11	ScREW, 8-32 x 5/8"	91843	3
12	Threadlocker, Blue	90001	1
13	O-ring, 3.5mm, 28mm ID	93864	1

Bill of Materials

Ram-Air Installation

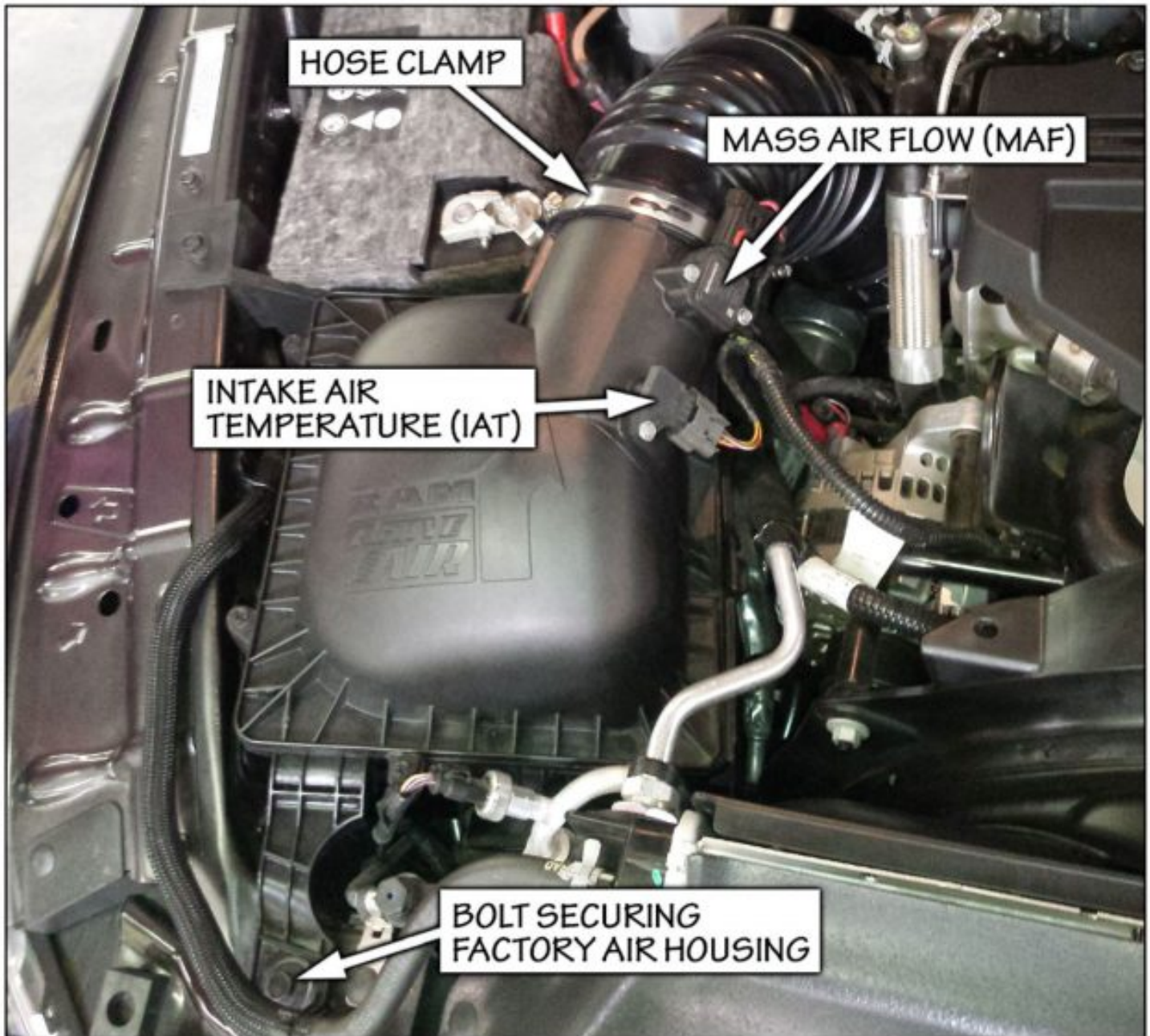

1. Remove the bolt, using a 13mm socket, from the radiator core support that secures the factory air housing and save for reuse.

2. Loosen the hose clamp to the stock

intake tube attached to the air housing.

3. Slide the red locking mechanism up on the Mass Air Flow (MAF) sensor connector.

Press the tab on the connector and remove the connector. Press the tab on the Intake Air Temperature (IAT) sensor connector and remove the connector. Pull the plastic anchor holding the wiring harness to the air housing lid and move the harness out of the way.

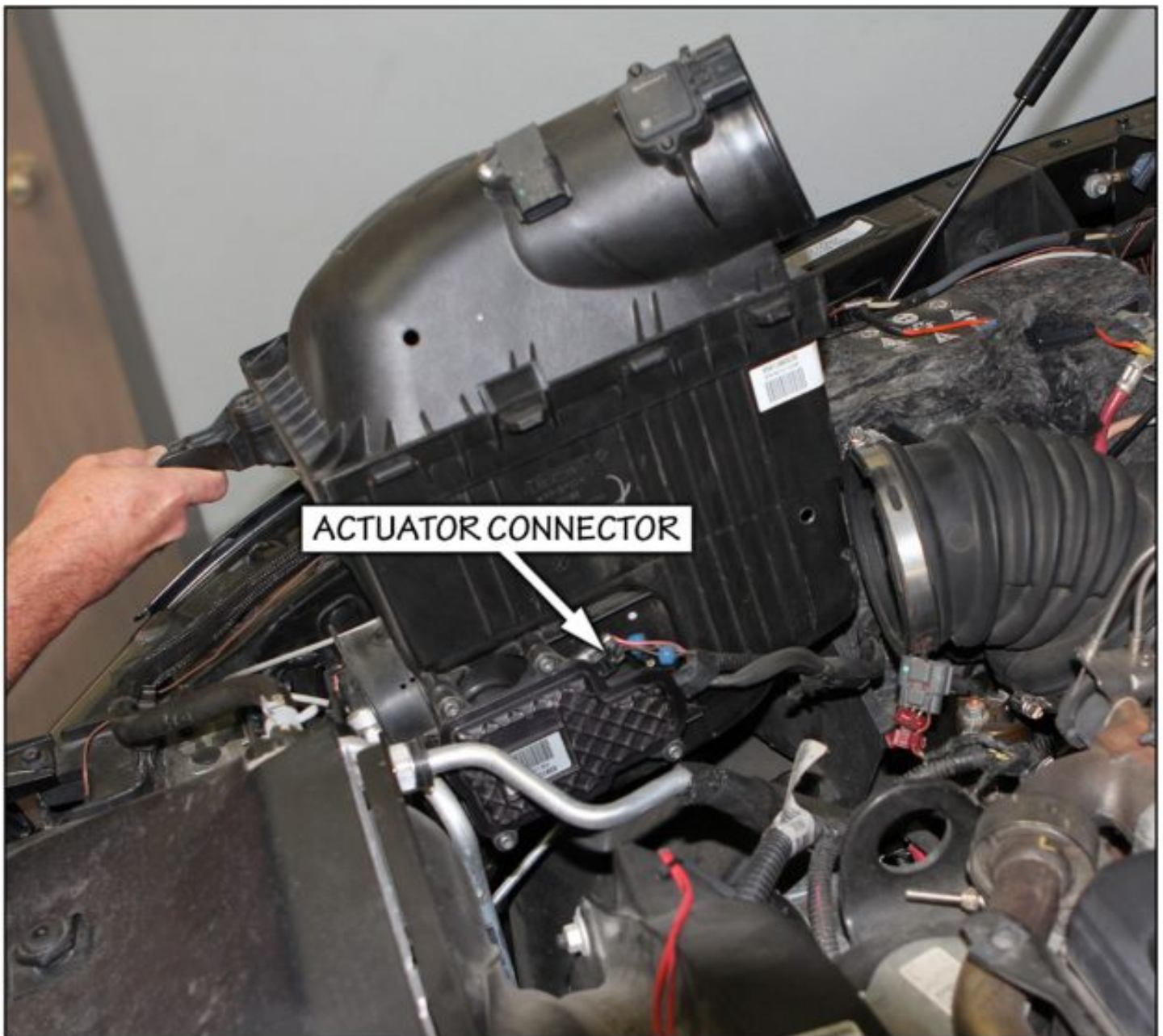

4. Lift the air housing up and partially out of the engine compartment to gain access to the Ram-Active Air[®] actuator connector on the actuator motor on the side near the bottom of the housing.

Be careful not to pull the housing up too far to damage the wiring harness. Once the housing is pulled out enough to gain access to this connector depress the tab on the end of the connector and disconnect the connector from the motor. The housing can now be removed completely from the vehicle and set aside for disassembly later.



5. Locate the spring clamp retaining the PCV hose.

Using appropriate pliers loosen the clamp and slide it up over the metal tube and out of the way. With the clamp out of the way pull the hose to disconnect from the metal tube. Remove the spring clamp and set it aside.



6. Loosen the hose clamp holding the intake tube to the compressor inlet and remove the intake tube from the vehicle.

7. The factory Ram-Active Air[®] actuator and door must be removed from the stock air housing and installed in the Banks Ram-Air housing.

NOTE:

It is important that the electrical connector be disconnected from the actuator motor before beginning to remove the actuator. Do not plug the connector back into the actuator until instructed to do so below after the actuator is completely reinstalled. Failure to do so can cause the actuator motor to rotate to a position that makes it impossible to install.

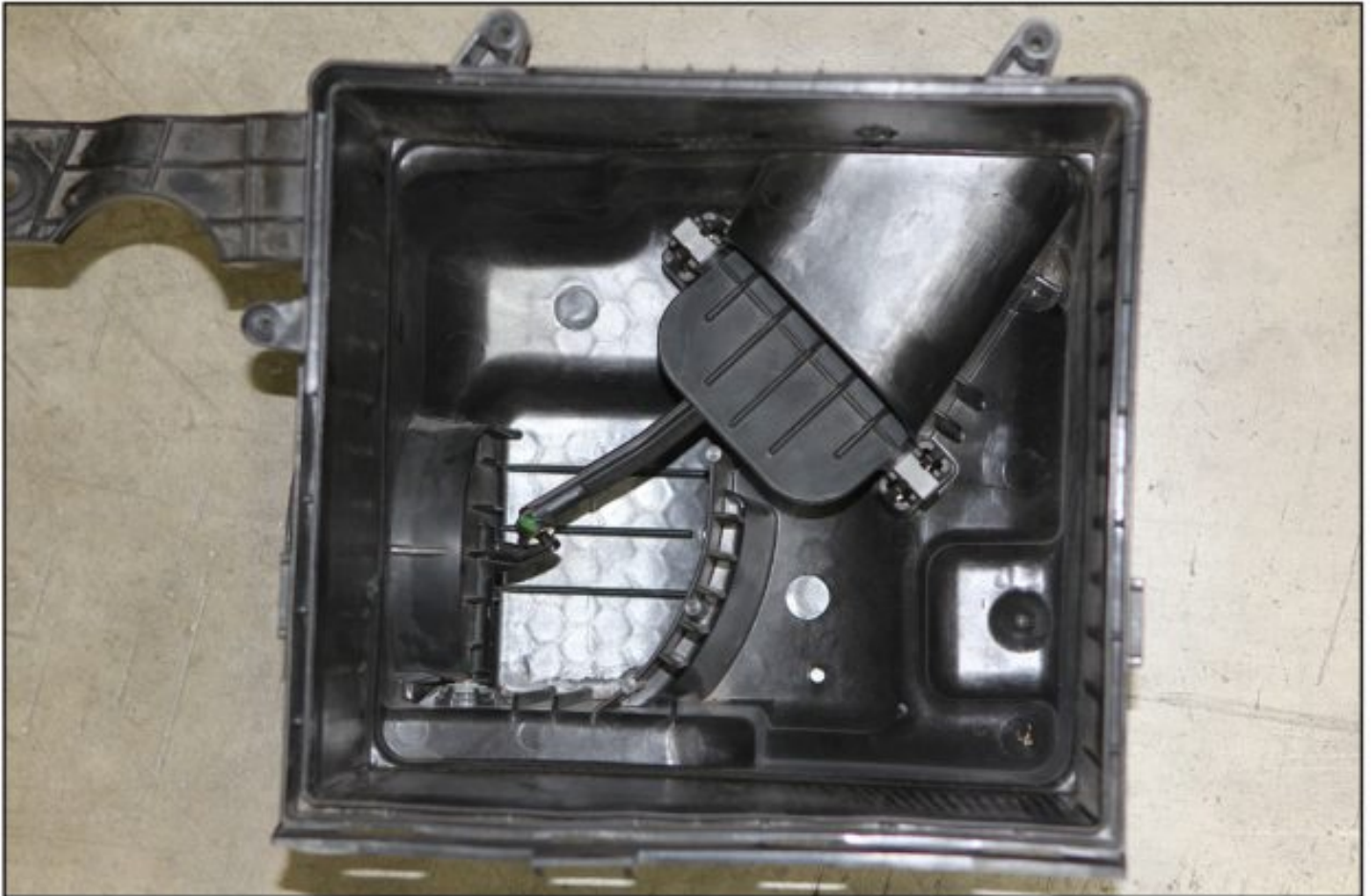

8. Remove the screws retaining the air housing lid and remove the lid and filter. Looking inside the housing you can see the stock Ram-Active Air® doors and linkage.



9. Remove the four screws retaining the actuator motor on the side of the housing using a T-30 Torx driver.



10. Using a flat blade screwdriver inserted between the Ram-Active Air® door and the side of the housing gently pry the door from the actuator motor shaft and pull the actuator motor from the housing.



11. With the actuator motor removed, the actuator door can now be disconnected from the linkage.

The lever arm on the door is fragile so care must be taken to disconnect the door from the linkage without breaking the arm on the door. To accomplish this, the arm on the door must be supported as close to the joint as possible and disconnect the joint by twisting and pulling simultaneously. Go slow. If the arm does break this will not affect the performance of this Banks Ram-Air Intake system but will prevent the stock function if ever returned to stock.



12. Install the Ram Active Air® and actuator motor into the Banks housing. Begin to insert the actuator motor from the side and hold the door over the actuator motor shaft.

Make sure the door and actuator motor are oriented correctly. When the door is fully inserted over the shaft you will feel a click and the door will not pull from the shaft easily.

13. Reinstall the four screws to retain the actuator motor.



14. Remove the IAT and MAF sensors from the stock intake using a 7mm socket. Replace MAF sensor O-ring with supplied 3.5mm O-ring. Install these sensors in the Banks Intake Tube using the supplied screws and a Phillips screwdriver.



15. Install the PCV hose and two hose clamps along with the compressor inlet hose and its two hose clamps onto the Banks Intake Tube in the orientation shown in the picture. Tighten the clamps retaining the hoses to the tube and leave the other clamps loose.



16. Install the Banks Ram-Air Filter onto the Intake Tube and secure it with the hose clamp. The hose clamp must be held up against the base of the filter while tightening the clamp.



17. Apply blue thread locker to 4 supplied window screw and use to install clear window onto the housing. Do not over-tighten the screw. They just need to be snug.

NOTE:

Window screws may vibrate loose if thread locker is not applied.



18. Install the filter into the housing ensuring that the filter is completely inserted into the housing.



19. Begin to install the Banks Ram-Air assembly into the vehicle.

Before completely install the housing, make sure to reconnect the wiring to the actuator motor. Also, reconnect the wiring to the IAT and MAF sensors and push the red locking mechanism down on the MAF connector.

20. Install the compressor inlet hose over the inlet of the compressor.

21. Insert the Banks housing down into the engine compartment pushing the pins on

the bottom of the housing into the rubber grommets on the fender well. Ensure the pins are engaged with the grommets by making sure the housing is firmly held in position.

22. Reinstall the bolt retaining the housing to the radiator core support.

23. Ensure the hose is still completely installed over the compressor inlet and tighten the clamp to secure the hose to the compressor.

24. Install the PCV hose over the metal tube of the PCV system along with the hose clamp. Once the hose is fully installed over the metal tube tighten the clamp to secure the hose.

NOTE:

On some vehicles the metal tube can become loose and move out of position. It may be necessary to move this metal tube in order for the PCV hose to fit correctly. Take care

when repositioning this metal tube to not use excessive force and damage the tube. If the PCV hose is too long it may need to be trimmed to prevent the hose from kinking.

Air Filter Cleaning

To clean your air filter, please refer to the instructions found [here](#).

Vehicle CARB EO Label Placement

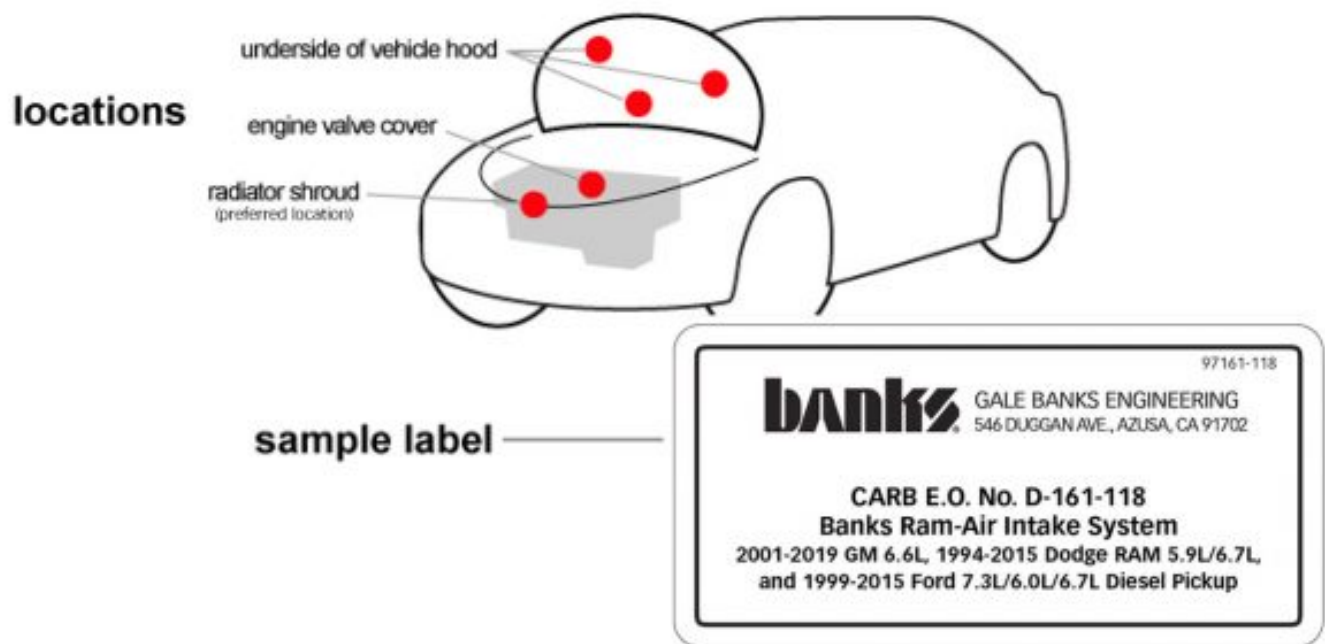

CARB EO LABEL

Please use the following CARB-approved emissions label and EO label location guidelines. We generally use the radiator shroud location.

Congratulations!

You've completed the installation of the Banks Ram-Air Intake System. Check all hose clamps for tightness and connectors for a sure fit. Ensure there is proper clearance around the intake tube and that all wiring is secured away from hot or moving parts.

[← Banks Air Filter Cleaning Instructions](#)
[97696 Banks PedalMonster – Stand-Alone Configuration →](#)

👍 You May Also Like



NEED HELP? Call **800-601-8072** from 7am-5pm Pacific.

Latest Videos

[View All](#)

➤ Subscribe to Banks Power channel

How to prevent RAM 6.7L grid heater bolt failure

How Banks got into diesel | Speed School Podcast Ep 13

Pics or it didn't happen!



bankspower

Turbochargin' since '58.
#bankspower
#banksbuilt
#houseofhorsepower
#galebanks
#galebanksracingengines
#banksspeedschool

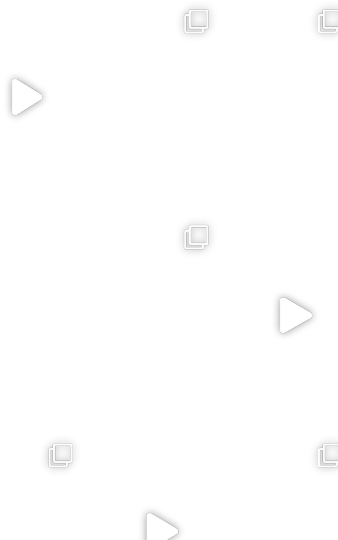

★ Popular

↺ Recent



6.6L
Crate
Engine



Owners
Manuals



Derringer L5P
Tuner for the
2017-
2019
Duramax

x: Real Power is here!



Why
EGT is
Important

[Load More...](#)[Follow us on Instagram](#)

I've raced & built engines since '56. Since '65 my favorite performance tool has been the turbocharger, I boosted my first diesel in '78, set a few records too!

Our mission is to improve performance, durability and the driving experience, all without compromising emissions requirements.

Questions?

Ask us anything.

Power...

Durability...

Efficiency! You want it, we have it!!

Nobody knows it better than us.

[Privacy Policy](#)

[Sitemap](#)

Contact Us

Call 800-601-8072

Mon-Fri 8am-5pm
Pacific Time

[Send us a message](#)

Fax 626-691-2122

546 S Duggan
Avenue
Azusa, CA 91702

[Map/Directions](#)

Looking to buy Banks?

[Banks Performance
Catalog](#)

[Banks Power
Parts Store](#)

[Shop online 24/7](#)

or visit our
PowerHouse

Gas & Diesel Performance for Cars, Trucks, Jeeps and Motorhomes

Copyright © 2022 Gale Banks Engineering. All rights reserved.

